

DEMOLITION NOTES:

- 1 REMOVE FENCE.
- 2 REMOVE TREE.
- 3 REMOVE STORM DRAIN.
- 4 SAWCUT AND REMOVE ASPHALT PAVEMENT.
- 5 REMOVE WATER VALVE.
- 6 SEE ARCH. FOR BUILDING DEMO.
- 7 SAWCUT AND REMOVE CONCRETE SIDEWALK PAVEMENT.
- 8 EXISTING WATER SERVICE TO BE REMOVED.

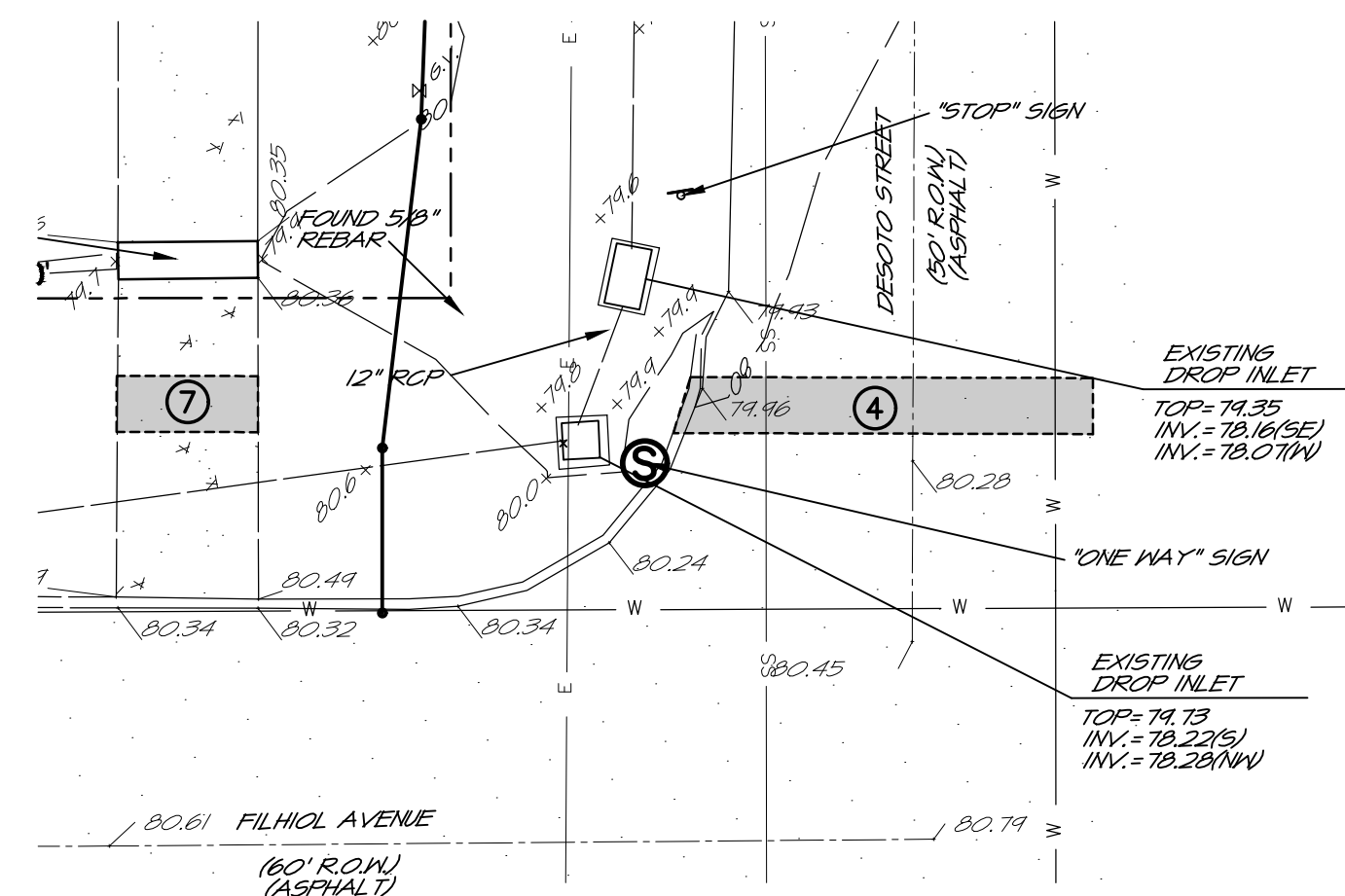

TBA STUDIO  
ARCHITECTURE  
103 Cypress Street  
West Monroe, LA 71291  
Tel. 318.340.1550  
Fax. 318.998.1315  
www.tbastudio.com

# TBA

SCHOOL OF CONSTRUCTION PRACTICE  
LAB BUILDING, UNIVERSITY OF  
LOUISIANA MONROE

507 Filhol Ave, Monroe, LA 71203

No.	Description	Date

DRAWN BY:	ADF
CHECKED BY:	MWS
SHEET	
C1.01	
Date:	NOV 2025
Project No.:	24-0059
File Name:	
DESCRIPTION:	
EXISTING CONDITIONS AND DEMOLITION PLAN	

MARK W. SNOW  
LICENSE NO. 24203  
PROFESSIONAL ENGINEER

CONSULTING ENGINEERS  
3003 KNIGHT STREET, SUITE 120  
SHREVEPORT, LOUISIANA 71105  
phone: 318-425-7452 fax: 318-425-4622  
www.AFJMc.com

ENGINEER: MARK W. SNOW, P.E.  
LICENSE NO. 24203

THESE DRAWINGS DO NOT INCLUDE NECESSARY COMPONENTS FOR CONSTRUCTION SAFETY. 25-033